



INSTRUCTION



● Thank you for purchasing KOSO mini LCD engine hour meter, please read the instruction thoroughly before installing.

Notice

- The LCD meter is applicable for CR 2032.
- For installation, please follow the steps described in the manual. Any damage caused by wrong installation shall be imputed to the users.
- Do not disassemble or change any parts excluding the manual description.
- The interior examination or maintenance should be executed by our professionals.

MARK MEANING:

NOTE You could get the installation details from the information behind the mark.

△ Some processes must be followed to avoid the affection caused by wrong installation.

WARNING! Some processes must be followed to avoid damages to yourself or the public.

CAUTION! Some processes must be followed to avoid the damage to the vehicle.



PRESS THE BUTTON ONE TIME

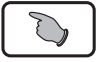

PRESS THE BUTTON 3 SECONDS

1 Accessory

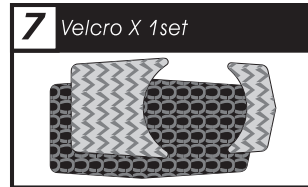
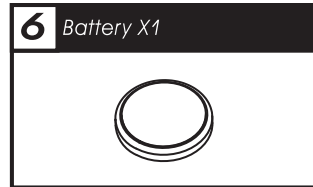
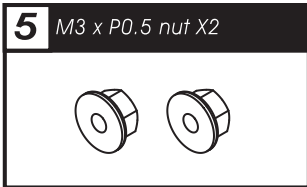
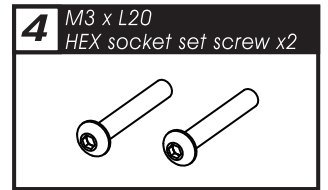
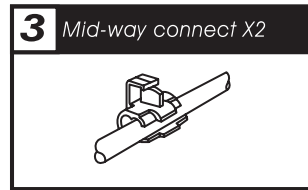
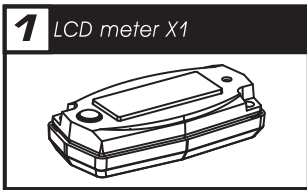

NOTE Please contact the local distributor if the items you open are not the same, with the above-listed one.

2-1 Installation instructions

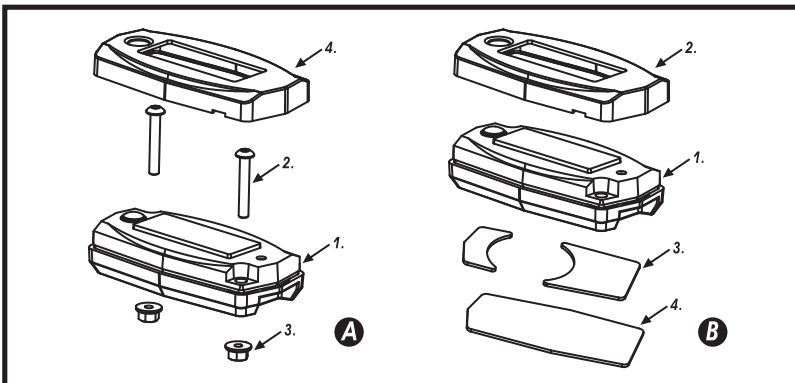

Follow those steps when installing.

- A**
1. LCD meter (Accessory 1)
 2. HEX socket set screw (Accessory 4)
 3. Nut (Accessory 5)
 4. Meter Cover (Accessory 2)
- B**
1. LCD meter (Accessory 1)
 2. Meter Cover (Accessory 2)
 3. Velcro-Male (Accessory 7)
 4. Velcro-Female (Accessory 7)

NOTE Please choose either Method A or B according to your need to install

2-2 Wiring installation instructions

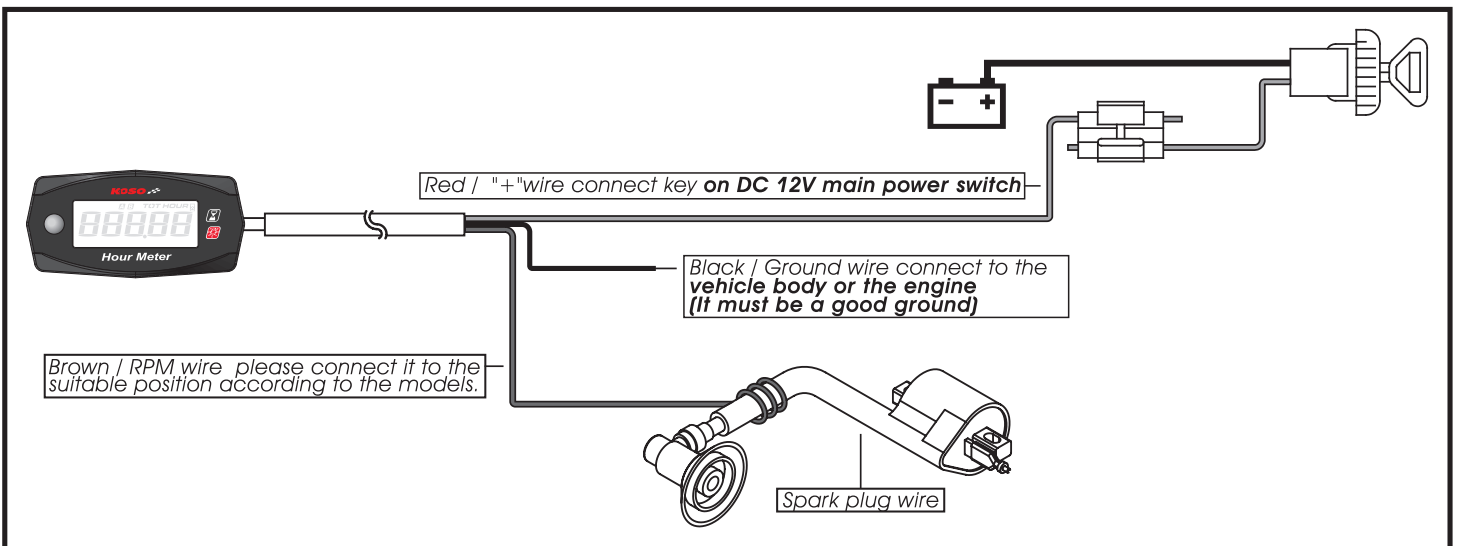

2-3 Battery installation instructions

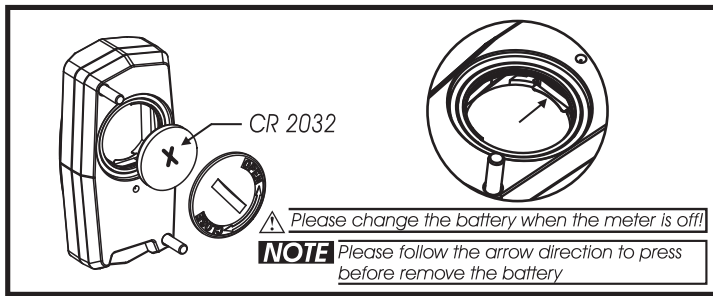

2-4 New ignition system

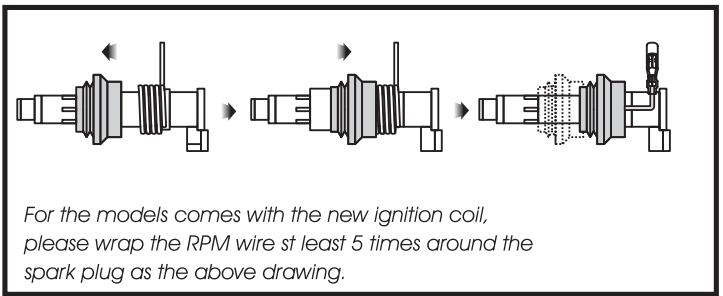

3 Instruction of function

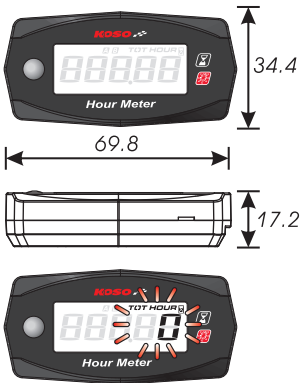

● Total hour meter	Display range : 0~99999 H Display unit : 1 H
● hour meter A/B	Display range : 0.0~999.9 H Display unit : 0.1 H
● Supply voltage	DC 12V
● Battery type	CR 2032
● battery life time	About 350 H (when battery volume below 250 mAh)
● Effective temperature range	-10~60°C
● Meter standard	JIS D 0203
● Meter size	W69.8 X L34.4 X H17.2 mm
● Meter weight	About 47.6g

NOTE Design and specifications are subject to change without notice!

EX.

4 Hour meter A, B & reset

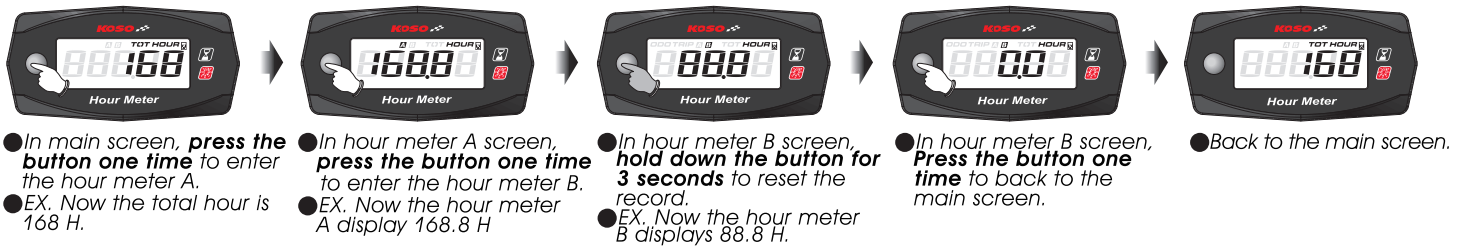

NOTE The meter will turn off automatically if you don't press the button or there is no signal input for seconds.

5 Trouble shooting

The following situation do not indicate malfunction of the meter. Please check the following before taking it in for repair.

Trouble	Check item
The meter doesn't work when the power is on.	<ul style="list-style-type: none"> ● Maybe the problem is caused by the insufficient power → Please change the inner battery. (CR 2032.) ● Maybe the problem is caused by wrong battery installation → Please check is the battery direction is correct. ● Please check the RPM sensor wiring is connected correctly.

※ If still can't solve the problems according to the steps above, please contact with distributors or us.