



- Thank you for purchasing our product. Please, read the instructions thoroughly and retain them for future reference.

**⚠ Notice**

- Any damages caused by faulty installation shall be imputed to the users.
- Correct tools must be used for installation.
- Do not modify any parts unless it is specifically stated in the instructions.
- Maintenance and repairs should be executed by a professional only.

⊗ MARK MEANING:

**NOTE** You could get the installation details from the information behind the mark.

**⚠** Some processes must be followed to avoid the affection caused by wrong installation.

**⚠ WARNING!** Some processes must be followed to avoid damages to yourself or the public.

**⚠ CAUTION!** Some processes must be followed to avoid the damage to the vehicle.

**1 ACCESSORY**

**1 Adjustable tenioner x1**

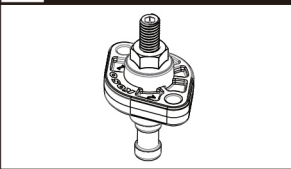

**2 Adjustable tenioner Plat x1**

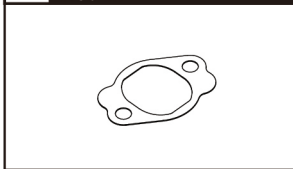

**NOTE** Please contact your local distributor if the items received are not the same as the one listed above.

**2 INSTALLATION INSTRUCTION**

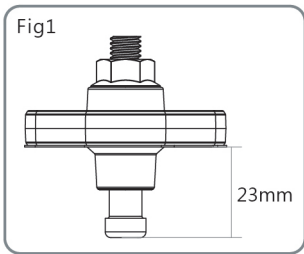
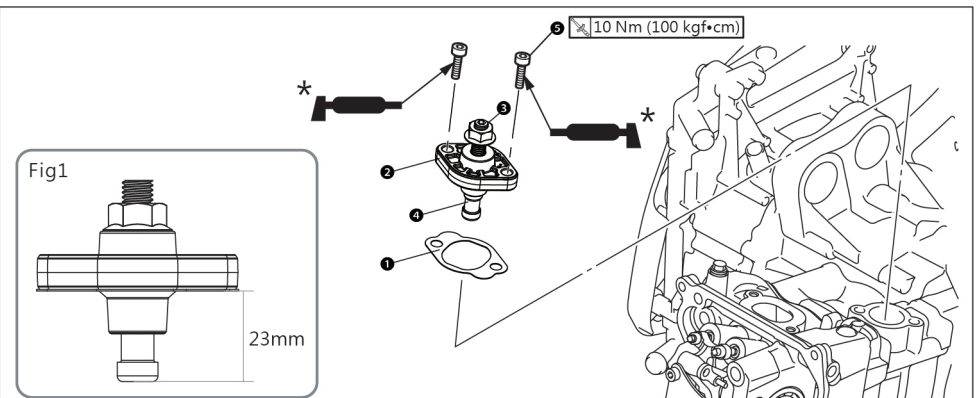

**PLEASE PROCEED AS FOLLOWS**

1. Please use appropriate tools to the loose the ③ nut.
2. Please align the ① adjustable tenioner plat (accessory 2) and ② adjustable tenioner (accessory 1) with the locking point of the car, and use appropriate tools to lock the ⑤ M6x20 screw to the attached adjustable tenioner.
3. Please use appropriate tools to the tighten the ④ adjusting screw until the bottom touches slightly, then tighten the nut by 1/2 turn.

**NOTE** The locking depth varies according to different models and vehicle conditions. For example, the adjustment depth of the original CYGNUS GRYPHUS is about 23mm, (Does not include the thickness of the gasket, as shown in Figure 1) and the actual depth needs to be adjusted according to the vehicle conditions.